

Password Change for Windows XP

- Windows will alert you at logon that your password will or has expired and prompt you to change it.

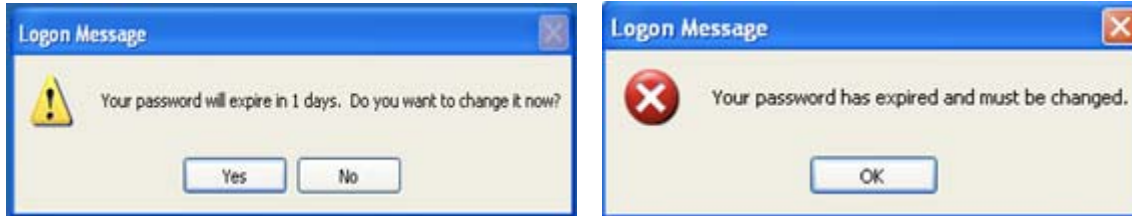

- As you logon, Windows will prompt you for the current password and the new password with a confirmation.



- Windows will display the following message when you have successfully changed your password:



How to Change Your Password at Any Time

- While logged into the computer, press Ctrl + Alt + Del and a menu will display:



- Select the "Change Password..." button and type in your current password and new password:



- Windows will display the following message when you have successfully changed your password:

